



FLUX

A modular seating unit that caters to the multiple needs of the future workspace. Aiming to disassociate work and stress, it is inspired by the idea of allowing the outdoors (a place typically thought of as a place of leisure) into a place of productive work.

INSPIRATION /

balancing act



workers needs



leisure & work



nature

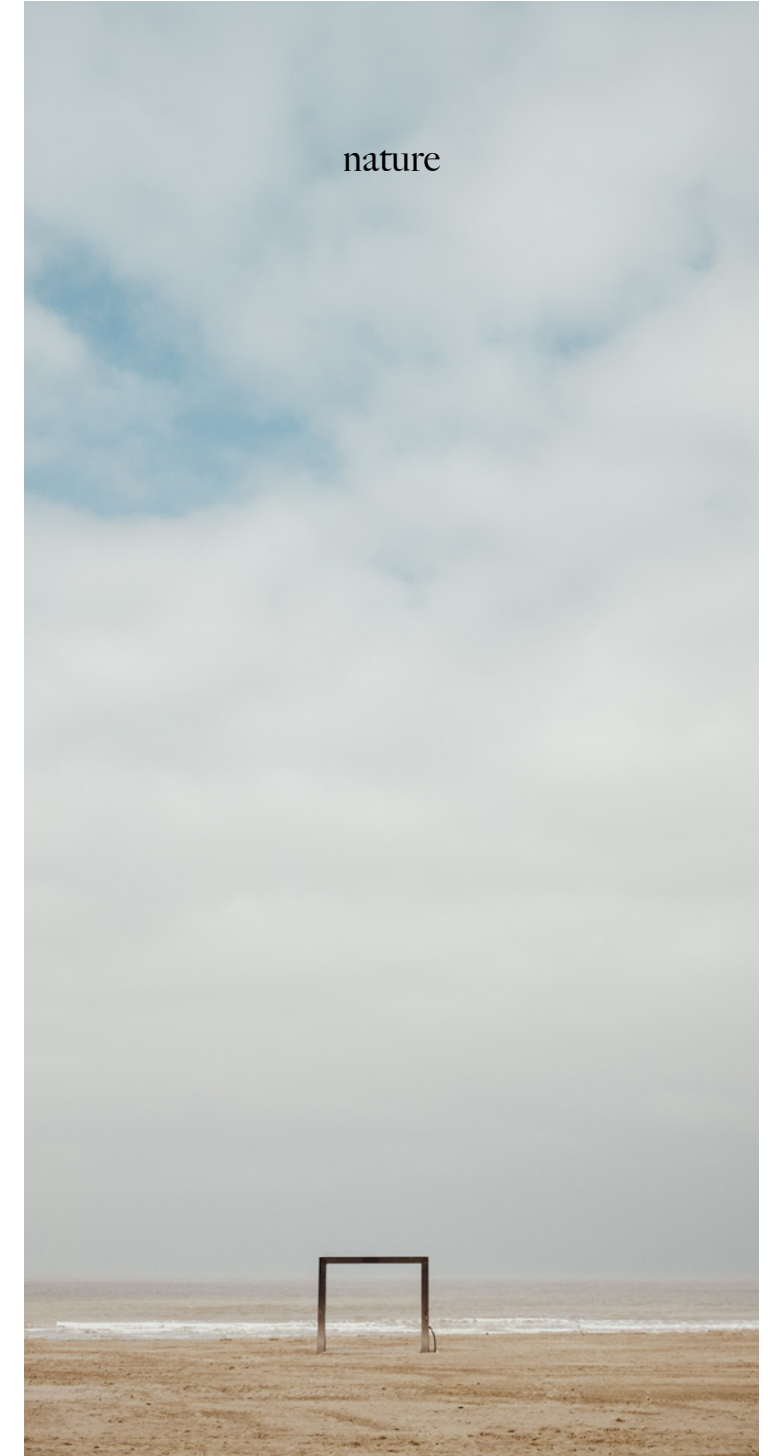



ottoman

Providing flexibility in seating positions, allowing the formation of collaborative communities.

table

Creating workable spaces as well as having the ability to store small objects.

corner

Allowing the feeling of being craddled in a corner and giving a sense of privacy by facing a certain direction.

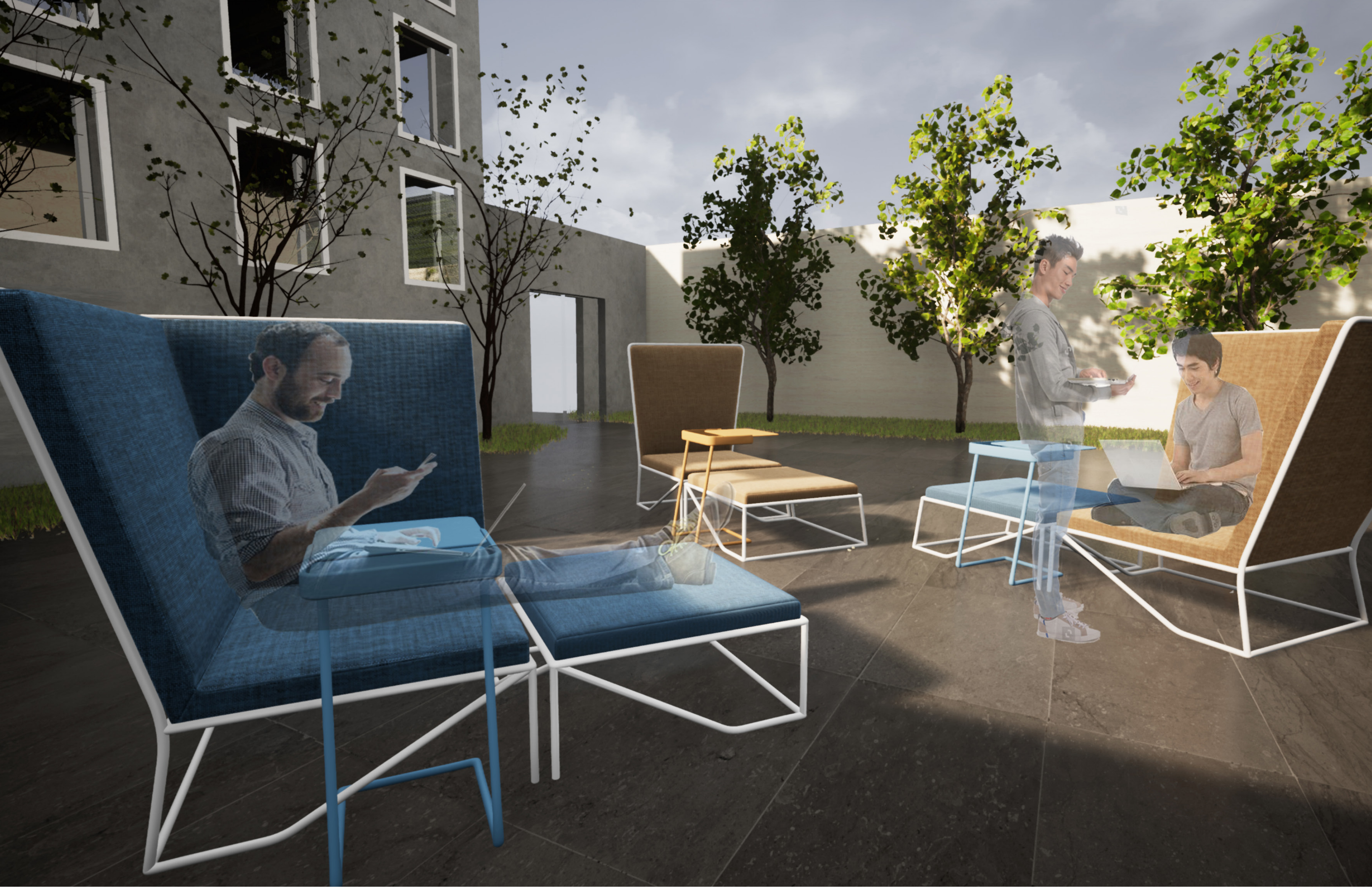

CONFIGURATIONS /

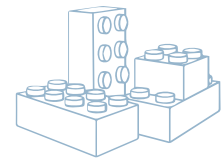

modular



balanced



productive



nature-inspired



collaborative



ORTHOGRAPHIC DRAWINGS /

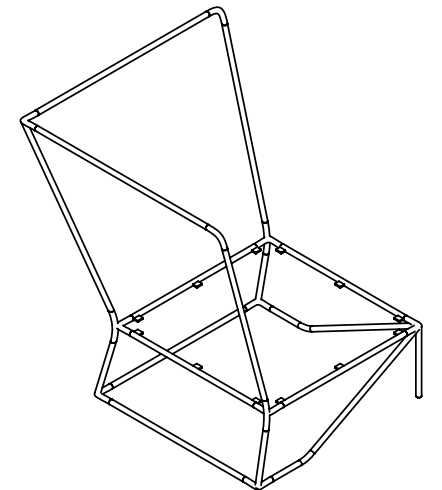
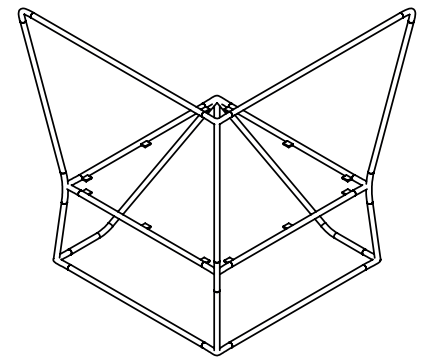
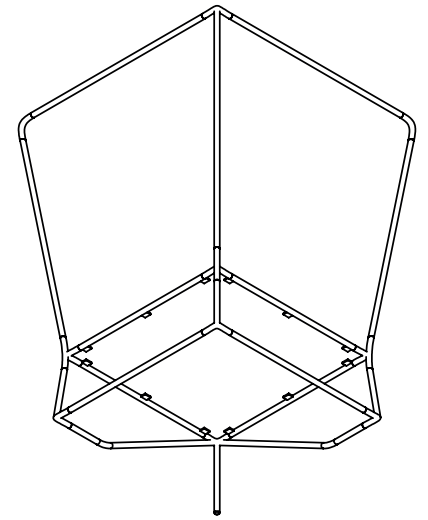
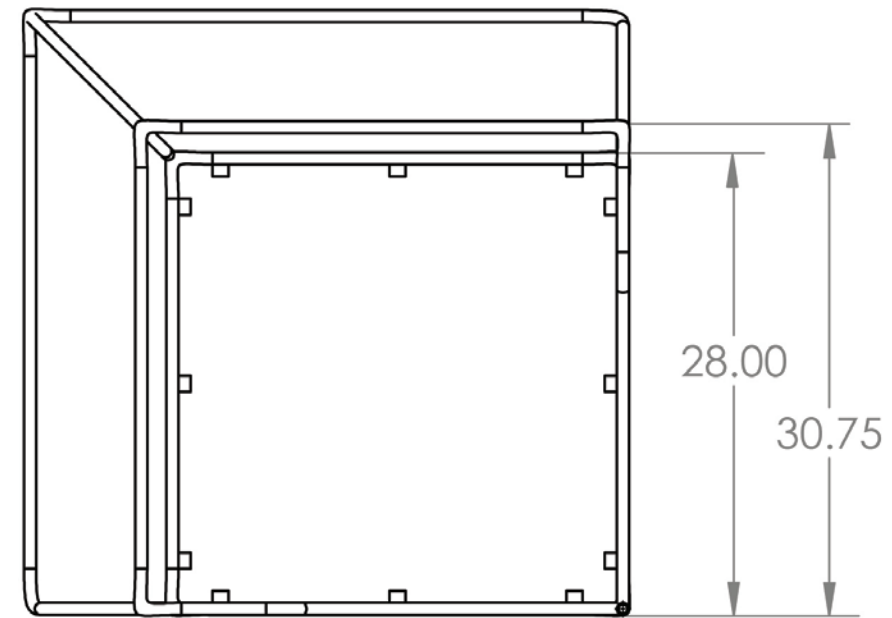
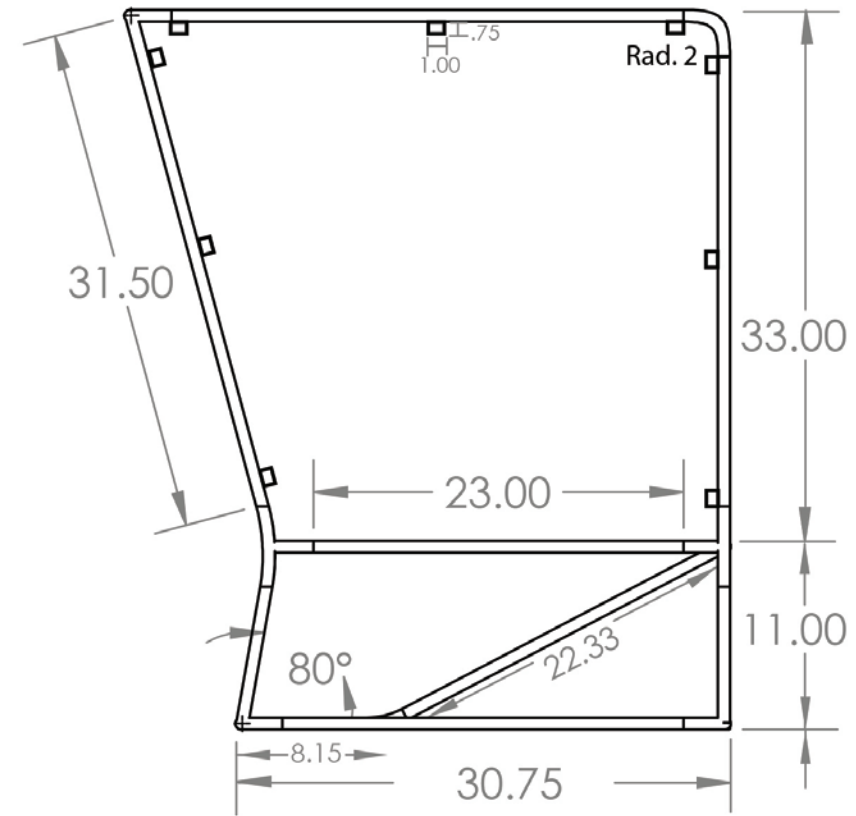
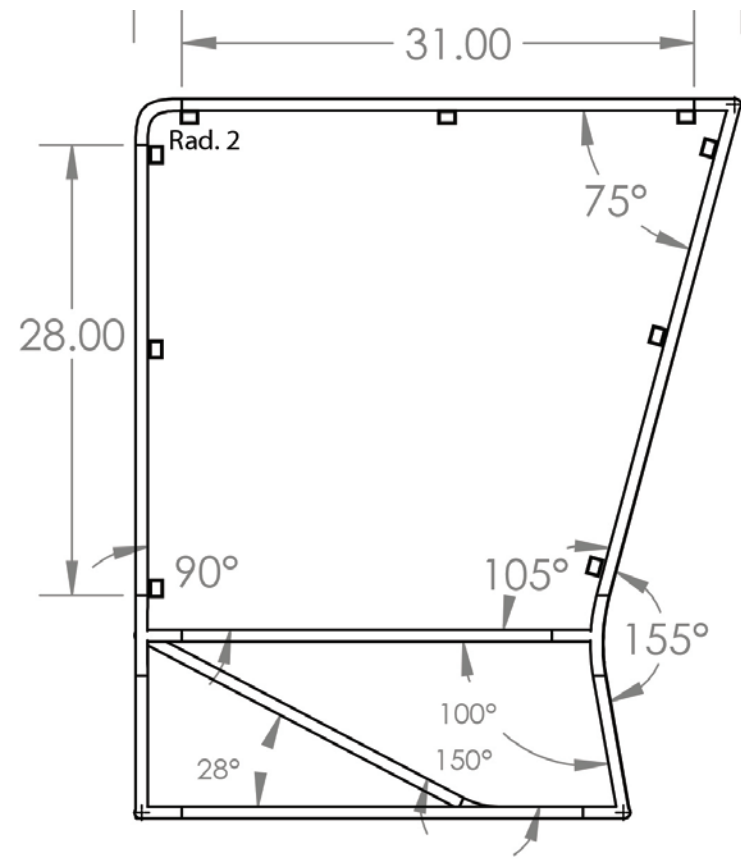

FLUX PROTOTYPE /

I made a full prototype for the final including an ottoman and a little vignette of possible arrangements.



THE MAKING PROCESS /

From sketches to 3D printing my very first miniature model and working with the metal fabricator to create my piece.

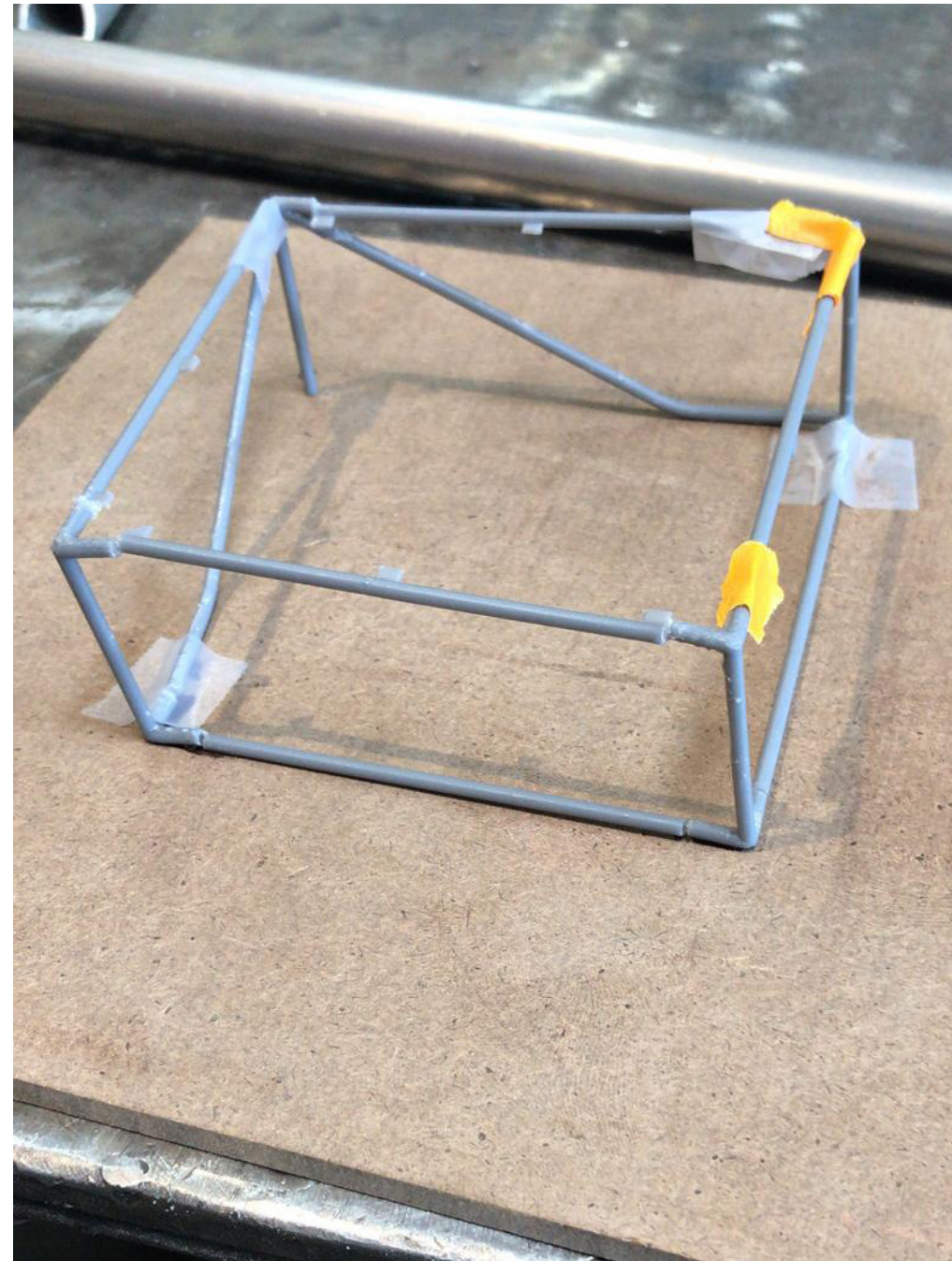
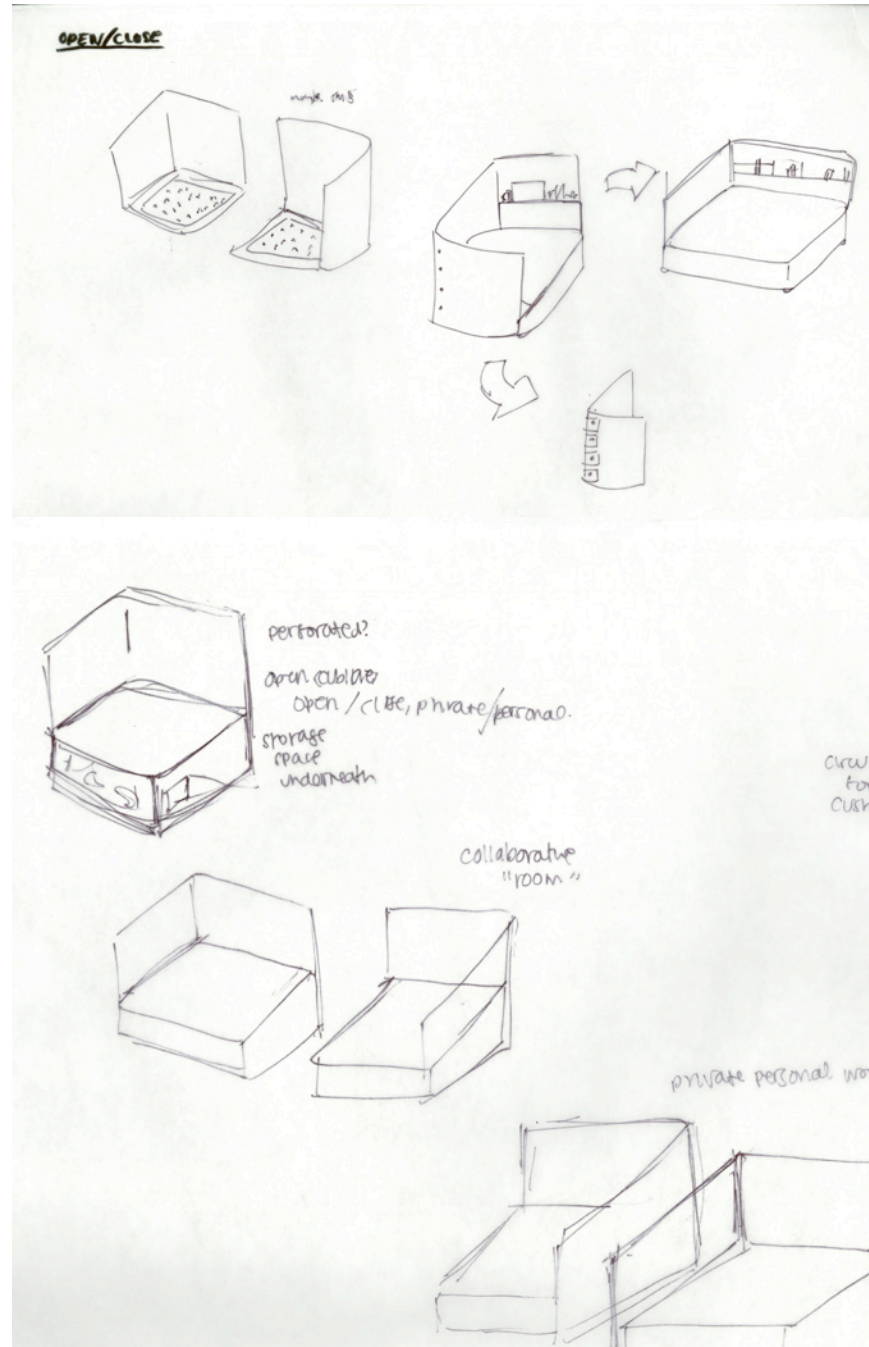

HAWORTH EXHIBITS /

Flux was presented at both Haworth HQ in Michigan and the new Haworth showroom during ICFE week in NYC.



HAWORTH EXHIBITS /

Flux was presented at both Haworth HQ in Michigan and the new Haworth showroom during ICFF week in NYC.

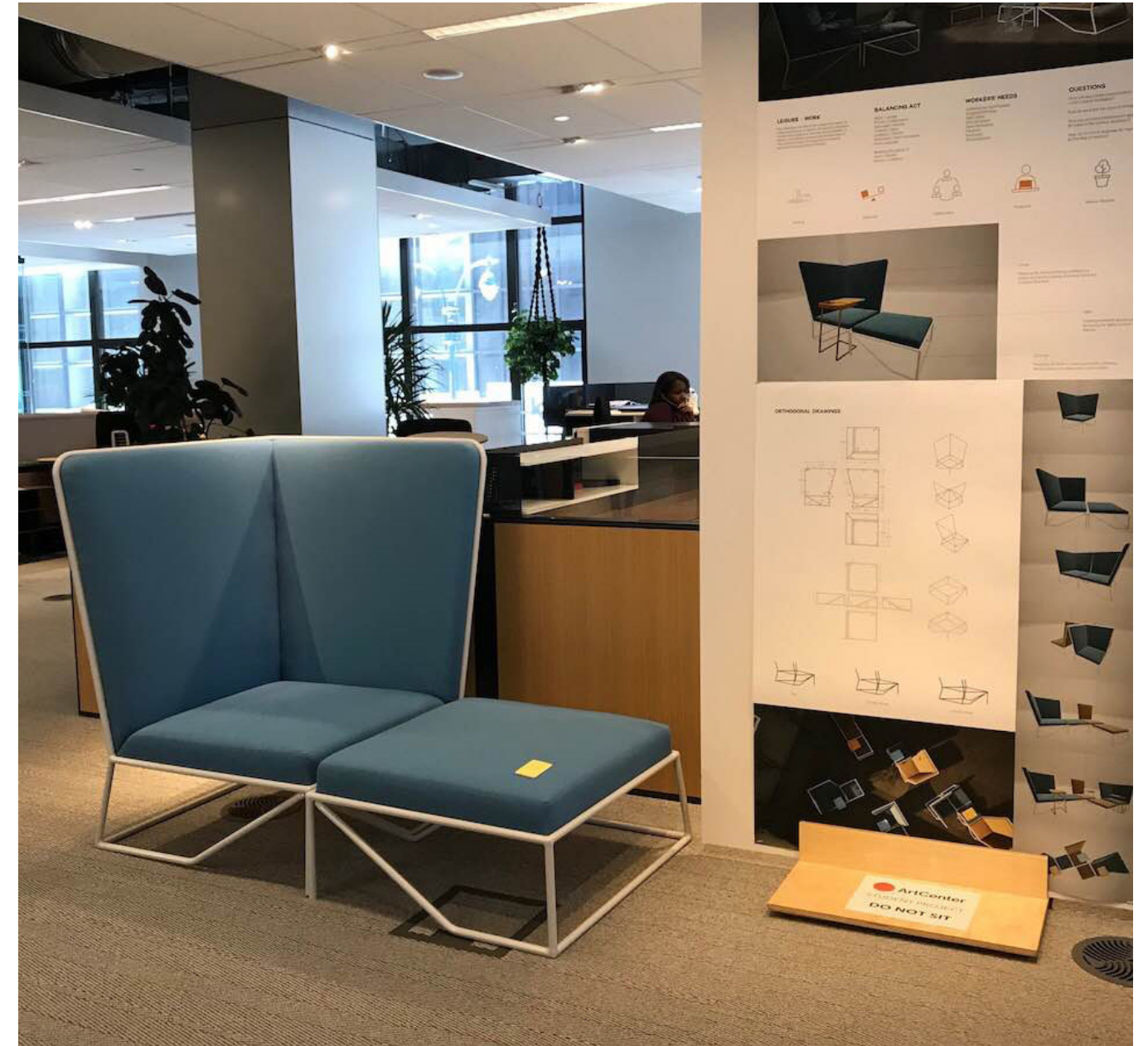



FLUX's key features lie in its metal legs. Inspired by the idea of balance, two sides of the legs lift up, allowing space for a side table to enter. The modular nature of the piece allows the chairs to form a community in of its own. The high backs provides the opportunity of privacy while being right next to one another, but doesn't block one's view from nature.

